

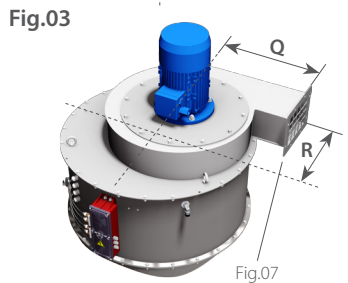

A- N- SEL.....S

A- N- SFL.....S

UPPER BODY

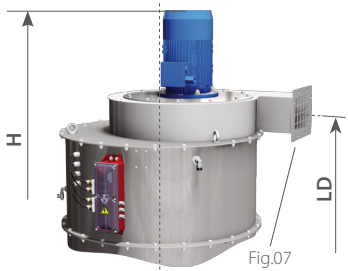
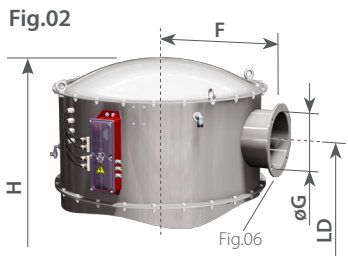
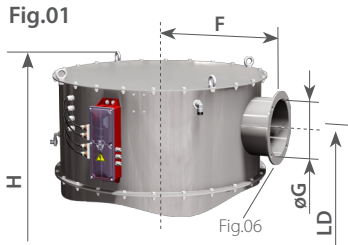

LOWER BODY



F - Without inspection door

E - With inspection door

* Nominal surface

CODE			Fig.	DN	H	LD	ØG	R	F	Q	Kg	m2*	Kw
ATEX	STD.	See combination table											
A-	N-	SFLD2A10S.A..ZZ.SA	1+6	350	1130	960	80	/	235	/	27	1	/
A-	N-	SFLD2A17S.A..ZZ.SA	1+6	350	1630	1460	80	/	235	/	34	1,7	/
A-	N-	S.LD3A21S.A..ZZ.SA	2+6	540	1165	980	168	/	370	/	65	2,1	/
A-	N-	S.LD3A39S.A..ZZ.SA	2+6	540	1665	1480	168	/	370	/	81	3,9	/
A-	N-	S.LD3A56S.A..ZZ.SA	2+6	540	2160	1975	168	/	370	/	91	5,6	/
A-	N-	S.LD3A73S.A..ZZ.SC	2+6	540	2660	2475	168	/	370	/	105	7,3	/
A-	N-	SELD4A48S.A..ZZ.SA	2+6	790	1225	940	219	/	495	/	110	4,8	/
A-	N-	SELD4A86S.A..ZZ.SA	2+6	790	1725	1440	219	/	495	/	135	8,6	/
A-	N-	SELD4B12S.A..ZZ.SA	2+6	790	2220	1935	219	/	495	/	154	12,4	/
A-	N-	SELD4B16S.A..ZZ.SC	2+6	790	2760	2435	219	/	495	/	177	16,2	/
A-	N-	SELD5A67S.A..ZZ.SA	1+6	950	1195	935	273	/	580	/	162	6,7	/
A-	N-	SELD5B12S.A..ZZ.SA	1+6	950	1695	1435	273	/	580	/	195	12	/
A-	N-	SELD5B17S.A..ZZ.SA	1+6	950	2190	1930	273	/	580	/	230	17,3	/
A-	N-	SELD5B23S.A..ZZ.SC	1+6	950	2690	2430	273	/	580	/	262	22,7	/
A-	N-	SELD5B25S.A..ZZ.SG	1+6	950	2930	2670	273	/	580	/	277	25,3	/
A-	N-	SELD6A93S.A..ZZ.SA	1+6	1100	1195	935	273	/	660	/	205	9,3	/
A-	N-	SELD6B17S.A..ZZ.SA	1+6	1100	1695	1435	273	/	660	/	246	16,7	/
A-	N-	SELD6B24S.A..ZZ.SA	1+6	1100	2190	1930	273	/	660	/	290	24,1	/
A-	N-	SELD6B32S.A..ZZ.SC	1+6	1100	2680	2430	273	/	660	/	331	31,6	/
A-	N-	SELD6B35S.A..ZZ.SG	1+6	1100	2930	2670	273	/	660	/	350	35,2	/
A-	N-	SFLH2A10S.A..A..SA	3+7	350	1460	1150	/	200	/	256	56	1	0,75
A-	N-	SFLH2A17S.A..A..SA	3+7	350	1960	1640	/	200	/	256	63	1,7	0,75
A-	N-	S.LH3A21S.A..A..SA	3+7	540	1485	1175	/	226	/	288	88	2,1	0,75
A-	N-	S.LH3A39S.A..C..SA	3+7	540	1985	1675	/	226	/	288	106	3,9	1,1
A-	N-	S.LH3A56S.A..E..SC	3+7	540	2510	2175	/	235	/	374	123	5,6	1,5
A-	N-	S.LH3A73S.A..E..SC	3+7	540	3010	2675	/	235	/	374	136	7,3	1,5
A-	N-	SELH4A48S.A..E..SA	3+7	790	1510	1180	/	300	/	400	140	4,8	1,5
A-	N-	SELH4A86S.A..E..SA	3+7	790	2010	1680	/	300	/	400	166	8,6	1,5
A-	N-	SELH4B12S.A..G..SC	3+7	790	2535	2175	/	300	/	400	188	12,4	2,2
A-	N-	SELH4B16S.A..G..SC	3+7	790	3035	2675	/	300	/	400	212	16,2	2,2
A-	N-	SELH5A67S.A..E..SA	3+7	950	1530	1200	/	345	/	484	197	6,7	1,5
A-	N-	SELH5B12S.A..G..SA	3+7	950	2060	1700	/	345	/	484	234	12	2,2
A-	N-	SELH5B17S.A..G..SC	3+7	950	2555	2195	/	345	/	484	269	17,3	2,2
A-	N-	SELH5B23S.A..L..SC	3+7	950	3085	2700	/	290	/	515	318	22,7	3
A-	N-	SELH5B25S.A..L..SG	3+7	950	3325	2940	/	290	/	515	334	25,3	3
A-	N-	SELH6A93S.A..E..SA	3+7	1100	1530	1200	/	526	/	430	239	9,3	1,5
A-	N-	SELH6B17S.A..G..SA	3+7	1100	2060	1700	/	526	/	430	284	16,7	2,2
A-	N-	SELH6B24S.A..L..SC	3+7	1100	2585	2200	/	580	/	310	345	24,1	3
A-	N-	SELH6B32S.A..L..SC	3+7	1100	3085	2700	/	580	/	310	386	31,6	3
A-	N-	SELH6B35S.A..M..SG	3+7	1100	3390	2940	/	580	/	310	414	35,2	4



FASTENING FLANGES AT THE BASE

Fig.05

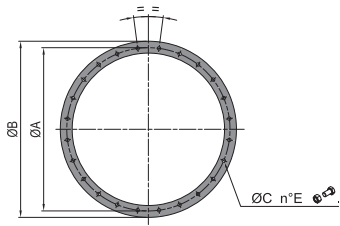

DN	ØA	ØB	ØC	n°E	
350	382	402	9	12	M8
540	570	590	9	16	M8
790	820	840	9	24	M8
950	996	1024	11	28	M10
1100	1154	1182	11	32	M10

OUTLET FLANGES

Fig.06

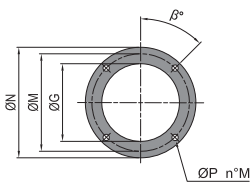

DN	ØG	ØM	ØN	ØP	n°M	β°
350	80	130	160	14	4	45
540	168	200	228	14	4	45
790	219	250	278	14	4	45
950	273	300	328	14	8	22,5
1100	273	300	328	14	8	22,5

FANS FLANGES

Fig.07

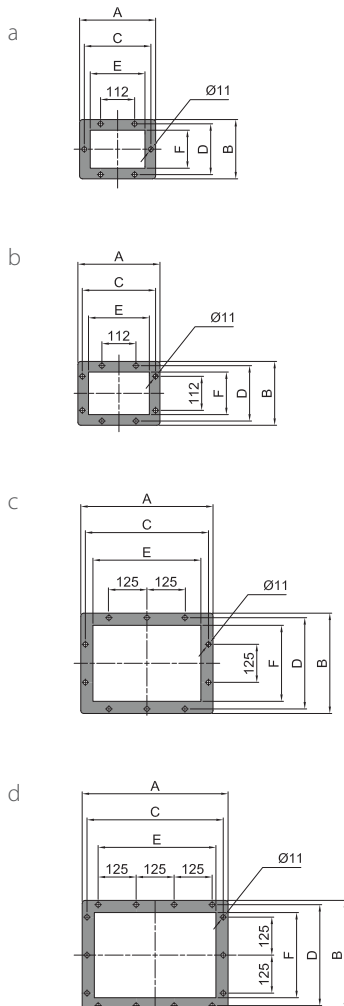

TYPE	Fig.	Kw	A (mm)	B (mm)	C (mm)	D (mm)	E (mm)	F (mm)
MBS330	07a	0,75	230	182	200	153	156	112
MBS360	07a	1,1	230	182	200	153	156	112
MBS385	07a	1,5	250	195	219	167	180	125
MBS415	07a	2,2	250	195	219	167	180	125
MBS430	07b	3	270	210	241	182	200	140
MBS460	07b	4	270	210	241	182	200	140
MBV420	07c	5,5	435	330	405	300	355	250
MBV450	07c	7,5	435	330	405	300	355	250
MBV500	07d	11	480	360	448	332	400	280

PACKAGING

A Packaging above a pallet (upright);
Protected by a carton box, or bubble wrap

B Packaging above 2 pallets (upright),
head and Venturis not installed;
Protected by a carton box, or bubble wrap

C Horizontal packaging above a wooden bed;
Protected by a carton box, or bubble wrap

Fig. A



Fig. B

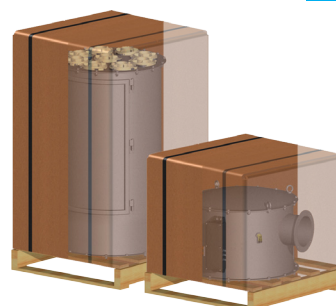

Fig. C

